



## 6 x 10 Hardware Shed

Call toll-free: 1.866.297.3760

A structure with personality this cottage is truly unparalleled. The different wall-heights help add to the curious shape. Further enhancing the design is the single arched door and the off set window. Request one or both sides of the roofing metal be replaced with a translucent fiberglass panel so the cottage can be used as a seedling starter.

Hand made in Vermont, from native rough sawn hemlock and pine lumber, this cottage is delivered fully assembled to your prepared site. Rugged post and beam techniques, passed down through the centuries, are used to construct this sturdy picturesque retreat, reminiscent of old New England. Have your own Vermont cabin in the woods!

All of our wood sheds, storage sheds, outdoor storage sheds, garden sheds, storage shed kits, cottages and utility enclosures are built of the finest Vermont lumber and hand-crafted for long life and durability. New England weather can really put a wood garden shed or cottage to the test, and Jamaica Cottage Shop's products have proven to stand the test of time and strength.

### Included with Kit:

- \* All Fastening Hardware
- \* Step - by - Step Plans
- \* Note: Configuration can be reversed

### Specifications:

**Square Footage:** 60 sq ft

**Overall dimensions:** 11' 2" W x 7'2" L x 10'6" H

**Recommended Foundation:** 3" – 4" Crushed Gravel

**Floor:** Two 4x6x10' Hemlock Skids

2x6 Hemlock 24" on center

3/4" CDX Plywood Flooring

**Walls:** 4x4 Post and Beam Wall Framing

60" Wall Height 36" Wall Height - Interchangeable

**Doors:** Single 3-0 JCS-Built Arched Door

**Windows:** One 16"x21" - 4 Light Fixed Barn Sash Window

**Roof:** 2x6 rafters 24" on center

12/12 Roof Pitch

1x4 Strapping 20" on center

1x6 Rough Cut Hemlock Collar Ties

Corrugated 29 Gauge Metal Roofing: Evergreen

**Siding:** 1" Rough Cut Pine Board & Batten Siding

1" Rough Sawn Pine Corner, Door & Window Trim

2" Rough Sawn Pine Trim Fascia & Shadow

### Wood Louvered Vent

**Assembly Time:** Two People, 20 hours

**Weight:** 1800 lbs.

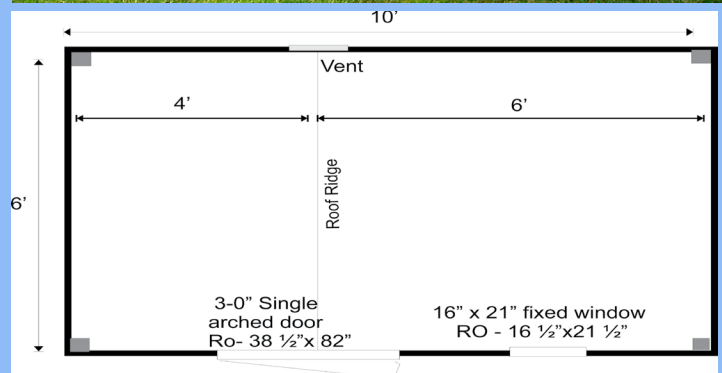

### Additional Options

Roof Color Change	\$50.00
Flower Box	\$48.00
16"x21"Hinged Window	\$105.00

### Plans \$50.00

Jamaica Cottage Shop, Inc. engineered the plans for our designs to do-it-yourself homeowners. The detailed plans include foundation options, a shopping list, and a color coded cut list. The trigonometry of the roof triangles has all been simplified with tracing the cut out roof templates. The plans are set for full dimensional lumber and provide a clear step-by-step path.

### Complete Kit \$2,997

The rough sawn native Vermont lumber package has all the pieces cut and ready for assembly. It includes a cut and notched hemlock post and beam frame and pre cut pine siding. The fasteners, hardware, windows, and doors are included as well as the step by step plans. The kit is geared to a do-it-yourself homeowner with beginner knowledge of carpentry.