



10 x 8 Saltbox

Call toll-free: 1.866.297.3760

This simple and practical design is strong enough to withstand the pesky critters that frequent our area. The double doors allow for easy access, making stored items effortless to get to. Use this little shed as a great storage area for bicycles or small yard tools.

Hand made in Vermont, from native rough sawn hemlock and pine lumber, this cottage is delivered fully assembled to your prepared site. Rugged post and beam techniques, passed down through the centuries, are used to construct this sturdy picturesque retreat, reminiscent of old New England. Have your own Vermont cabin in the woods!

All of our wood sheds, storage sheds, outdoor storage sheds, garden sheds, storage shed kits, cottages and utility enclosures are built of the finest Vermont lumber and handcrafted for long life and durability. New England weather can really put a wood garden shed or cottage to the test, and Jamaica Cottage Shop's products have proven to stand the test of time and strength.

- Included in the kit:**
- All Fastening Hardware
 - Step-by-Step Plans

Specifications:

Square Footage: 80 sq ft

Overall dimensions:

8'9" wide x 10'6" deep x 8'6" high

Recommended Foundation:

3" – 4" Crushed Gravel

Floor: Two 4x6x10' Hemlock Skids

2x6 Hemlock Joists 24" on center

3/4" CDX Plywood Flooring

Walls: 4x4 Post & Beam Wall Framing

83" Front Wall Height 63" Rear Wall Height

Doors: 5' JCS-built Double Doors with

3x5 Treated Ramp

Roof: 2x6 Rafters 24" on center

6/12 Roof Pitch Front, 6/12 Rear

1x4 Strapping 20" on center

Roofing: 29 Gauge Corrugated Metal Roofing, Color: Evergreen

Siding: 1" Thick Rough Cut Pine Board & Batten

1" Rough Sawn Pine Trim includes Fascia,

Shadow, Corner and Door Trim

Shipping Cube Size 48" W x 42" H x 121" L

Kit Weight: 4200 lbs.

Assembly Time: One person, 24 hours

Fully Assembled \$3,100

Fully assembled from native rough sawn lumber here at our manufacturing facility, this design is delivered to your client prepared, truck accessible site in one piece. The building is set and leveled by our delivery crew and ready to use when we leave your site. Due to road restrictions, fully assembled models are available in the northeastern United States only.



Photo may not show standard Option A, Please refer to floor plan below and specifications to the left.

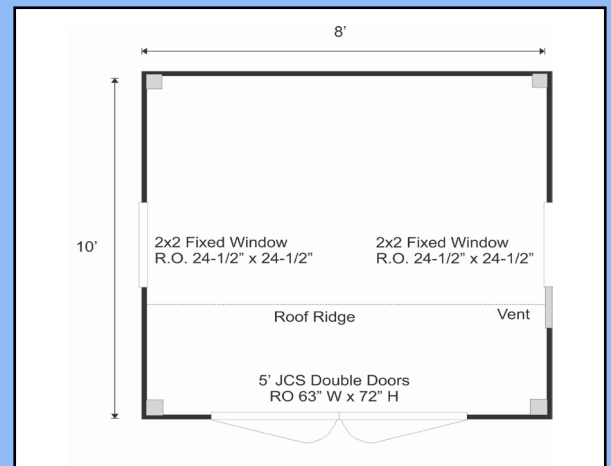

Roof Color Change \$50.00

Complete Kit \$3,100

Plans \$50

The rough sawn native Vermont lumber package has all the pieces cut and ready for assembly. It includes a cut and notched hemlock post and beam frame and pre cut pine siding. The fasteners, hardware, windows, and doors are included as well as the step by step plans. The kit is geared to a do-it-yourself homeowner with beginner knowledge of carpentry.

Jamaica Cottage Shop, Inc. engineered the plans for our designs to do-it-yourself homeowners. The detailed plans include foundation options, a shopping list, and a color coded cut list. The trigonometry of the roof triangles has all been simplified with tracing the cut out roof templates. The plans are set for full dimensional lumber and provide a clear step-by-step path.